

Model No.: LV400CH

levoit

Ultrasonic Cool Mist Humidifier

Questions or Concerns?

Please contact us Mon-Fri 9:00AM-5:00PM PST
at (888) 726-8520 or email support@levoit.com

Thank you.

Thank you for purchasing the LV400CH Ultrasonic Cool Mist Humidifier by Levoit. We are dedicated to providing you with quality products so that you can see a better you. Should you have any questions or concerns about using your new product, feel free to reach out to our helpful customer support team at (888) 726-8520 or by email at support@levoit.com. We hope you enjoy your new product!



Safety Information

IMPORTANT: Please read, understand, and comply with all of the instructions provided in this manual before using the device. Failure to comply with the instructions given in this manual and/or using the device in ways other than the ones mentioned in this manual may result in serious injury and/or damage the product.

- Ensure that the plug fits properly into a polarized power socket.
- Always disconnect from a power source by pulling the plug when not in use.
- **DO NOT** use this product in wet environments.
- **DO NOT** use your hand or any other object to cover the nozzle while the unit is on. Doing so may damage the product.
- **DO NOT** clean the unit while it is connected to a power source or while it is on.
- Remove the water tank from the base before moving the humidifier.
- **DO NOT** place the humidifier near sources of heat, such as stove tops, ovens, radiators or computers.
- **DO NOT** place the humidifier near any large pieces of furniture or in any high-traffic area where it can be easily knocked over.
- Unplug the unit when not in use, or while cleaning it out.
- **DO NOT** use cleaning detergents to clean the humidifier; only use distilled white vinegar.
- **DO NOT** plug in the unit with wet hands.
- **DO NOT** place foreign objects into the unit's base or water tank. Do not use other items as replacement parts for this product.
- Keep the machine out of reach of children.
- Only use this air purifier as described in this manual.
- Contact customer service if the unit is damaged or if it is not functioning properly.



Main Functions

1. Nozzle
2. Water Tank
3. Water Tank Window
4. Water Filter Cap
5. Night Light
6. Power Button
7. Base
8. Inner Chamber
9. Atomization Chip
10. Floater Cartridge
11. Aroma Box
12. Aroma Pad
13. Filter

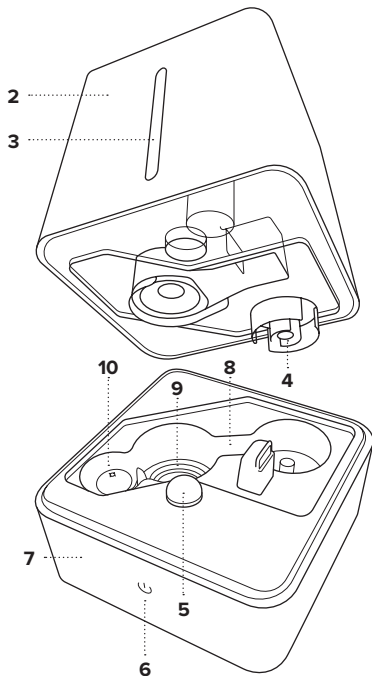
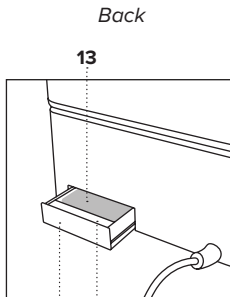
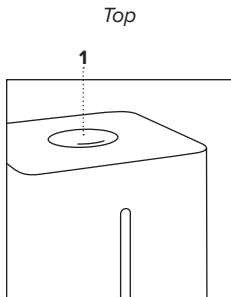



Set-Up

1. Remove the water tank from the base.
2. Flip the tank over and unscrew the water tank cap.
3. Fill the tank with cold or room temperature water; use distilled water for best results. You can gauge how much water is in the tank by looking through the water tank window.
4. Replace the cap once you have filled the tank to your desired level.
5. Carefully place the water tank back on the base, aligning the water tank window with the power button.

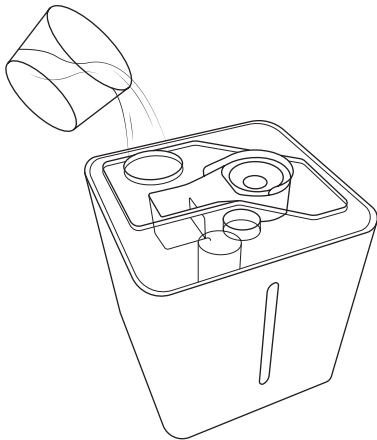
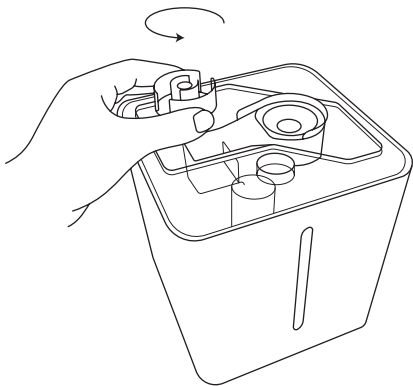

NOTE:

- For best results, fill the water tank with distilled water.
- **DO NOT** fill the tank with hot water for operation.
- **DO NOT** add water through the nozzle.



Operation

1. Plug the unit in an electrical outlet.
2. Press the power button once to set the the humidifier the low mist setting. The power button will light up blue.
3. Press the power button again to set the unit to the high mist setting. The power button will light up purple.
4. (Optional) Press and hold the power button for 2 seconds to turn on or turn off the built-in night light.
5. Press the power button once more to turn off the humidifier.
6. When the water level is low, the power button will flash red and the unit will automatically turn off. The night light will stay on if the humidifier shuts off due to low water level.
7. Unplug the humidifier and refill the water tank as mentioned in the Set-up section.

NOTE:

- The nozzle can rotate 360° to diffuse mist in any direction.
- While the humidifier is operating, the power button light will automatically turn off after 30 seconds of inactivity. To check or change the current mist setting, simply press the power button again.

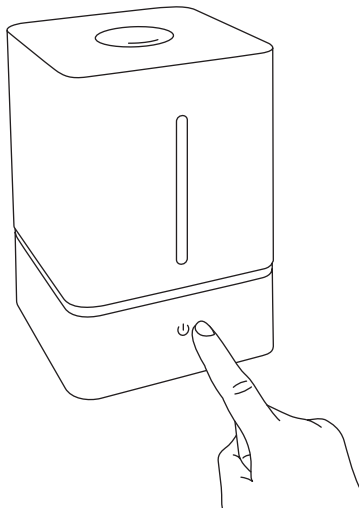

Using the Aroma Box

Your new humidifier can also be used as an aroma diffuser to provide added comfort in your home.

1. Unplug the humidifier from its power source.
2. Remove the aroma box from the back of the base.
3. Add 2-3 drops of essential oil on the aroma pad.
4. Replace the aroma box. Fill the water tank with water and place it back on the base as mentioned in the Set-up section.
5. Plug in and turn on the humidifier to relax with your favorite fragrance.

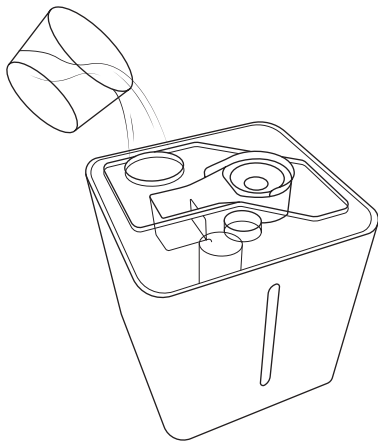
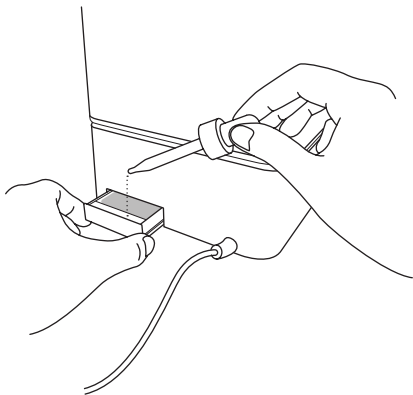



Care & Maintenance

Make sure the humidifier is completely unplugged from any power source when cleaning.

1. Unplug the humidifier.
2. Remove the water tank from the base and pour out any excess water. Fill the tank with 1 cup of distilled white vinegar and evenly coat all sides of the water tank.
3. Add a small amount of vinegar on the atomizer chip. Fill the inner chamber with water.
4. Allow the vinegar to soak inside of both the water tank and inner chamber for 30 minutes.
5. Pour out the vinegar from both parts of the humidifier and thoroughly rinse with warm water.
6. Fill the water tank with 2 cups of distilled water and set the humidifier on the high setting for 15 minutes.
7. Pour out excess water and dry all parts with a dry, clean cloth. Store in a covered space when not in use.

NOTE: The water in the inner chamber near the atomizer chip may still be warm after turning off the unit. Use caution when pouring out the water.

Cleaning the Water Filter Cap

It is recommended to clean the water filter cap every 6 months. Remove the water filter cap and rinse it out with clean water and allow it to dry in the sun for at least 1 hour. Replace the cap back onto the water tank when it dries.

Removing & Cleaning the Nozzle

Remove water tank from the base and pour out any remaining water.

1. Align the arrow on the nozzle with mark on the water tank.
2. Slowly flip the water tank over to remove the nozzle.
3. Scrub the nozzle with a soft-bristled brush and warm water. Rinse and dry thoroughly.
4. Replace the nozzle onto the the water tank.

Cleaning the Aroma Pad

1. To clean the aroma pad, remove it from the aroma box and rinse under warm water.
2. Dry the pad with a clean cloth and place it back into the aroma box.



Troubleshooting

Problem	Cause	Solution
No mist coming out of nozzle.	Unit is not plugged in.	Plug into power source.
	Unit is not turned on.	Press the power button to turn on the unit.
	No water in tank.	Add water.
	Water level low.	Fill water tank with sufficient amount of water.
Unusual smell.	Unit is new.	Remove the water cap, and place the water tank in a cool, dry place for 12 hours.
	Dirty water, or water has been in tank for a long time.	Rinse and clean water tank and fill with clean water.
Unusual noise.	Tank is positioned incorrectly.	Align water tank window with the power button.
	Water level low.	Add water.
	Unit is not level.	Place unit on a flat, level surface.
Mist is coming out from base.	Water tank is not positioned correctly.	Turn off/unplug the unit, then align water tank window with the power button.



Specifications

Power Supply:	AC 120V/60Hz
Rated Power:	25W
Effective Range:	25-35m ³ (270-380ft ²)
Water Tank Capacity:	4 L (1.05 gal)
Max Moisture Capacity:	200 mL/h

Package Contents

- 1 x Ultrasonic Cool Mist Humidifier
- 1 x User Manual
- 3 x Aroma Pads



Customer Support

Should you encounter any issues or have any questions regarding your new product, feel free to contact our helpful Customer Support Team. Your satisfaction is our goal!

Levoit Corporation

1202 N. Miller Street, Suite A
Anaheim, CA 92806

Toll-Free: (888) 726-8520
Email: support@levoit.com

Support Hours

Monday - Friday: 9:00am - 5:00pm PST

**Please have your order number ready before contacting customer support.*



Warranty Information

Terms & Policy

Levoit warrants all products to be of the highest quality in material, craftsmanship and service for a minimum of 1 year, effective from the date of purchase. Warranty lengths may vary between product categories. Levoit will replace any product found to be defective due to manufacturer flaws based on eligibility; refunds are available within the first 30 days of purchase. This warranty extends only to personal use and does not extend to any product that has been used for commercial, rental, or any other use in which the product is not intended for. There are no warranties other than the warranties expressly set forth with each product. This warranty is non-transferrable. Levoit is not responsible in any way for any damages, losses or inconveniences caused by equipment failure or by user negligence, abuse, or use noncompliant with the user manual or any additional safety, use, or warnings included in the product packaging and manual.

This warranty does not apply to the following:

- Damage due to abuse, accident, alteration, misuse, tampering or vandalism.
- Improper or inadequate maintenance.
- Damage in return transit.
- Unsupervised use by children under 18 years of age.

Levoit and its subsidiaries assume no liability for damage caused by the use of the product other than for its intended use or as instructed in the user manual. Some states do not allow this exclusion or limitation of incidental or consequential losses so the foregoing disclaimer may not apply to you. This warranty gives you specific legal rights and you may also have other rights which may vary from state to state.

ALL EXPRESSED AND IMPLIED WARRANTIES, INCLUDING THE WARRANTY OF MERCHANTABILITY, ARE LIMITED TO THE PERIOD OF THE LIMITED WARRANTY.

Should your product prove defective within the specified warranty period, please return the defective unit in its original packaging with (1) an original copy of the invoice, (2) your order confirmation number, (3) and your warranty ID number.

To find out more about extending your warranty, visit www.levoit.com/warranty or contact customer support.

Date of Purchase: _____

Purchased From: _____

Order Number: _____

The logo for Levoit features the word "levoit" in a bold, lowercase, sans-serif font. A light blue, semi-circular arc is positioned above the letter "e", resembling a smile or a stylized "e" shape.

levoit

www.levoit.com